

KB DUCT

SERIES 1000 CLAMP

| Superior Ease of Use, Integrated Safety Lock, and Reusability

EASY TO INSTALL

The KB Duct Series 1000 Clamp, to be used with KB Duct Series 1000 Clamp Together Ducting, is designed for one handed operation to allow installers fast, safe, and reliable duct clamping.

FULL SUITE OF COMPONENTS

The Series 1000 Clamp is also optimized with KB Duct's full suite of Series 1000 Clamp Together products. From elbows to reducers and beyond the Series 1000 is the clamp you need to get the job done.

REUSABLE GASKET

Use the clamp over and over again as your system grows and changes.



SAFETY LOCK

Built-in lockout means no separate equipment needed (available in 7" dia and up).

ONE HANDED OPERATION

Your second hand is now free to align the duct.

APPLICATIONS

- Semiconductor
- Food & Beverage
- Pharmaceutical
- Pulp & Paper
- Chemical Production
- Wood Products
- Thin Films
- Battery/Fuel Cells

HOW TO ORDER

Contact KB Duct Headquarters or your Regional Sales Manager today to place an order for KB Duct's full suite of Series 1000 Products!

MATERIALS

The Clamp can be ordered in both Series 1000 Galvanized and Series 2000 Stainless Steel options. The Gasket is available in Nitrile, Silicone, ePTFE, and Viton depending on the temperature range of your system.

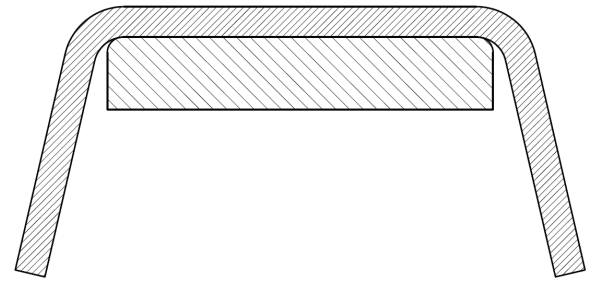

CROSS SECTION



Gasket

Nitrile
Silicone
ePTFE (Gore)
Viton

Operating Temperatures

-20°F to 185°F
-85°F to 400°F
-450°F to 600°F
-4°F to 435°F

Diameter (in)	Weight Galvanized (lbs)	Weight Stainless (lbs)
3"	0.168	0.170
4"	0.190	0.192
5"	0.247	0.250
6"	0.281	0.284
7"	0.570	0.576
8"	0.616	0.623
9"	0.742	0.750
10"	0.790	0.798
11"	0.910	0.920
12"	0.956	0.966
13"	1.008	1.019
14"	1.052	1.063
15"	1.109	1.121
16"	1.154	1.166
17"	1.202	1.215
18"	1.253	1.266
19"	1.301	1.315
20"	1,468	1.484
22"	1.563	1.580
24"	1.661	1.679

CONTACT US

Headquarters KB DUCT

8735 West Market Street
Greensboro, NC 27409
USA

Contact Info

Toll Free: 866.KNB.DUCT
(866.562.3828)
Phone: 336.668.3773
Fax: 336.668.0043

Central / West TIM MANGRUM

E: tmangrum@onececo.com
C: 469.275.3097

Great Lakes WILL PAPPANO

E: wpappano@onececo.com
C: 940.365.6520

South East SCOTT GILLIATT

E: sgilliatt@onececo.com
C: 336.225.8347